

Cut List for Platform A

- 1x1 box steel  
 1@ 12'- 8 7/8" LS  
 1@ 6'-1 1/4" L  
 1@ 5'-5 1/2" LL  
 1@ 4'-1 3/8" LL  
 1@ 3'-11 1/4" LS  
 1@ 2'-0 1/2" LS  
 1@ 9 1/4" L

- 1x2 box steel  
 1@ 17'-5 1/8" LS on edge  
 1@ 16'-1 5/8" LL on face  
 1@ 11'-11 1/4" LL on face  
 1@ 5'-7 7/8" LL on edge  
 1@ 4'-6 1/8" LL on edge  
 1@ 3'-10 5/8" L on face  
 1@ 3'-10 1/8" LS on edge  
 5@ 3'-10" (3) on face and (2) on edge  
 1@ 3'-9 1/2" L on edge  
 1@ 1'-0 1/8" L on face  
 1@ 10 1/4" LS on edge  
 1@ 8 5/8" LL on edge  
 1@ 8 3/8" LL on edge  
 8@ 8" on edge with 45 degree cut  
 1 inch from the top

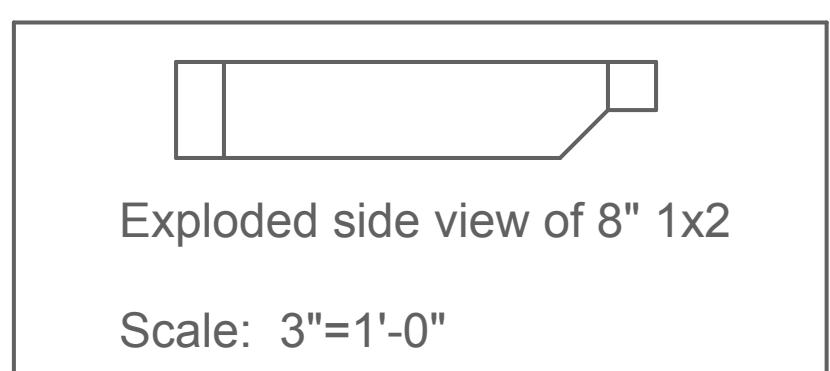

Angles for Platform A

Note: All angles are either 90 or 45 degrees unless otherwise noted.

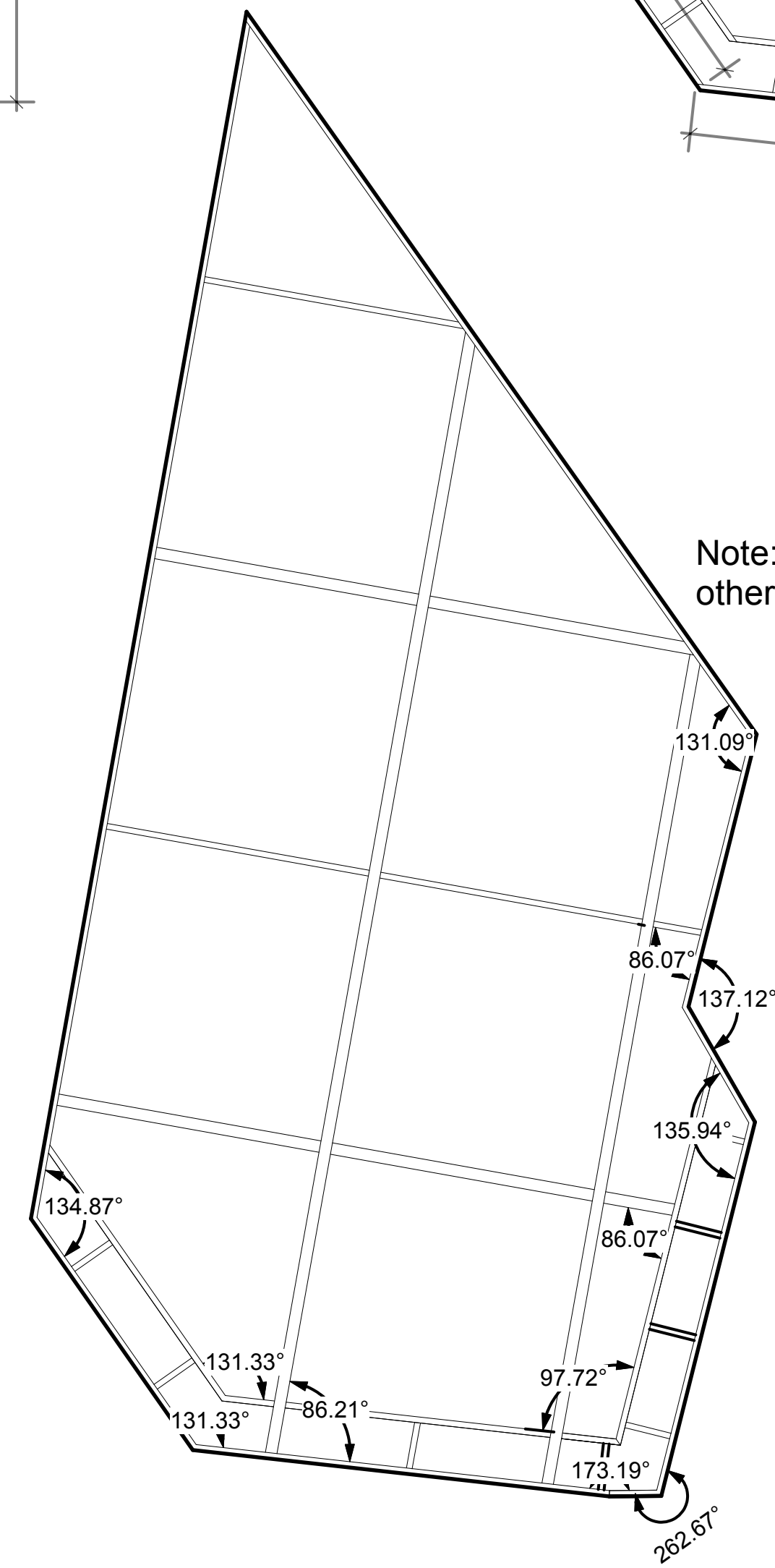

Cutlist for Platform C

- 1x1 box steel  
 1@ 12'-6" L  
 1@ 4'-2 5/8" LL  
 1@ 3'-2 1/4" LL  
 1@ 1'-2 3/8" LS  
 1@ 1'-0 1/8" LS
- 1x2 box steel  
 1@ 12'-6 1/2" LS on face  
 1@ 11'-9 1/4" L on edge  
 1@ 9'-7 1/2" L on edge  
 1@ 7'-6 3/4" L on edge  
 1@ 3'-8 1/4" on edge  
 1@ 3'-8 1/8" on face  
 1@ 2'-11 1/2" LL on edge  
 1@ 2'-10 5/8" on edge  
 1@ 2'-9 7/8" on face  
 1@ 2'-9 1/8" on edge  
 1@ 1'-10" L on edge  
 8@ 8" (1) on face (7) on edge with  
 45 degree angle cut 1 inch  
 from the top

Angles for Platform C

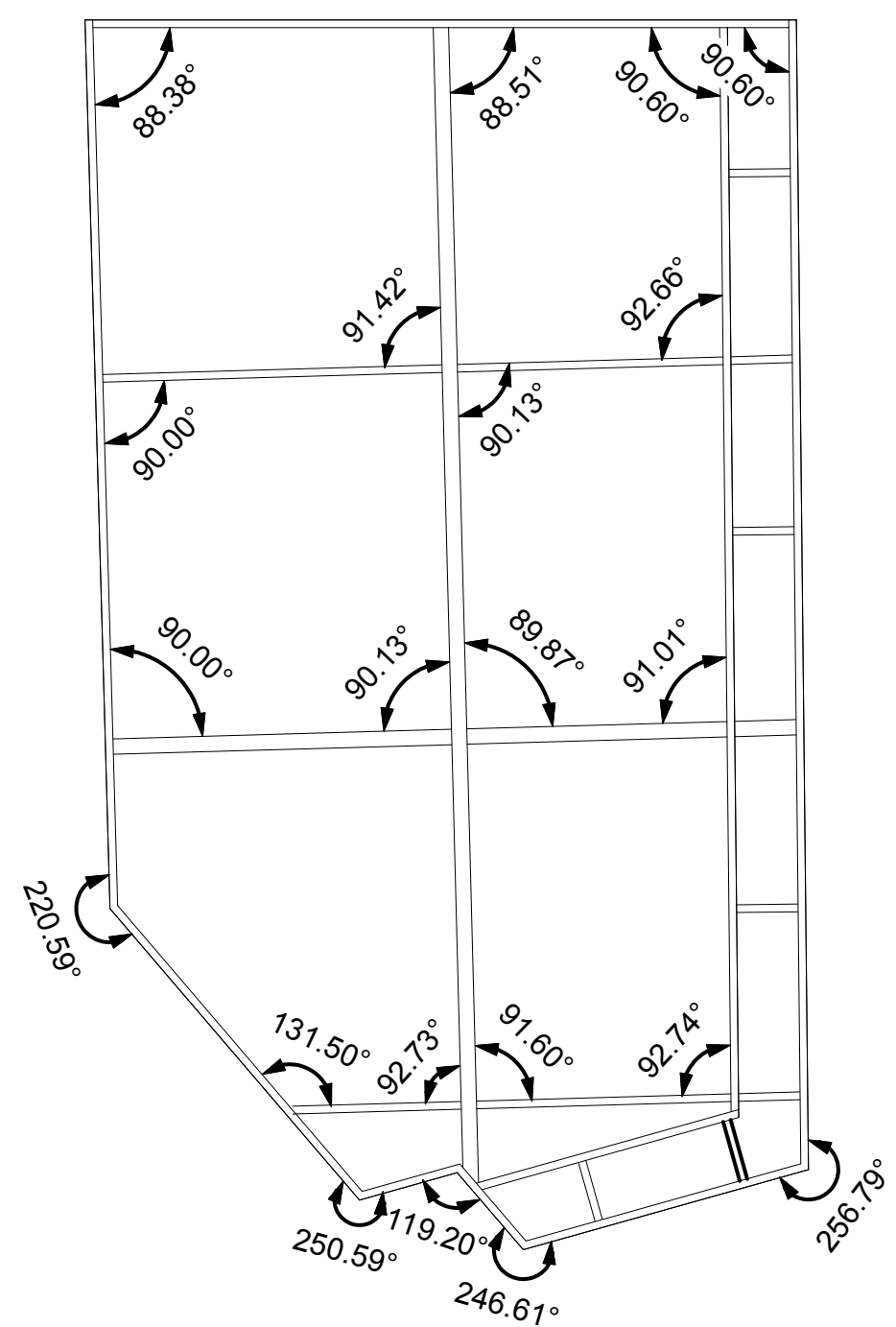

Notes:

- Look at the exploded view in bottom left and do this whenever 1x2 meets up with 1x1
- Build upside down and pay special attention to what is on edge and what is on its face
- Even though three platforms are shown, only build one of each

- L = 1 angle measured on the long side  
 LL = 2 angles both measured from the long to long side  
 LS = 2 angles measured from the long to the short side

University of Virginia			
God's Ear			
Platforms A and C details			PLATE NO.
DIRECTOR: Sandi Shiner			1
DESIGNER: Tom Bloom and Jason Randolph			OF
TECH DIRECTOR: Lauren Shell			
DRAFTER: Lauren Shell			
APPROVED	DATE	SCALE	DWG. DATE
		1/2" = 1'-0"	12.26.2012