

Cutlist for Water Wall

- 1x2 box steel
- 1@16'-0 1/8"
- 1@13'-5 5/8" LL on edge
- 1@13'-4" L on edge
- 1@12'-0" L on face
- 1@9'-11"
- 3@7'-10"
- 3@4'-10 1/8"
- 1@3'-10"
- 1@3'-0"
- 1@2'-11"

Note: The darker outline indicates where the plexi will be attached.

Stair unit A1

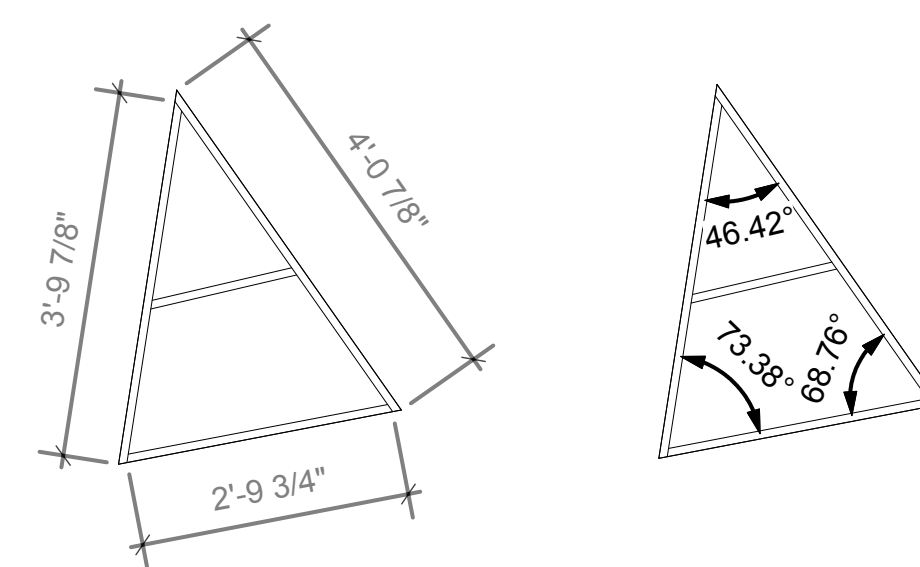

Cutlist for Stair Unit A1

- 1x1 box steel
- 1@4'-0 7/8" LL
- 1@3'-9 7/8" LL
- 1@2'-9 3/4" LL
- 1 toggle CTF
- 5@7"

+8"

Stair unit A2

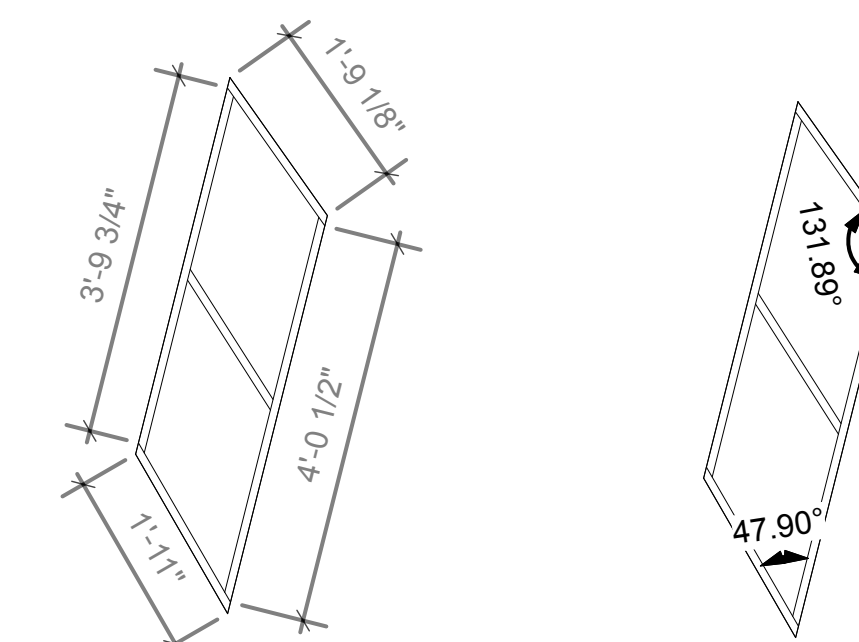

Cutlist for Stair Unit A2

- 1x1 box steel
- 1@4'-0 1/2" LS
- 1@3'-9 3/4" LS
- 1@1'-11" LS
- 1@1'-9 1/8" LS
- 1 toggle CTF
- 6@15"

+16"

Stair unit C1

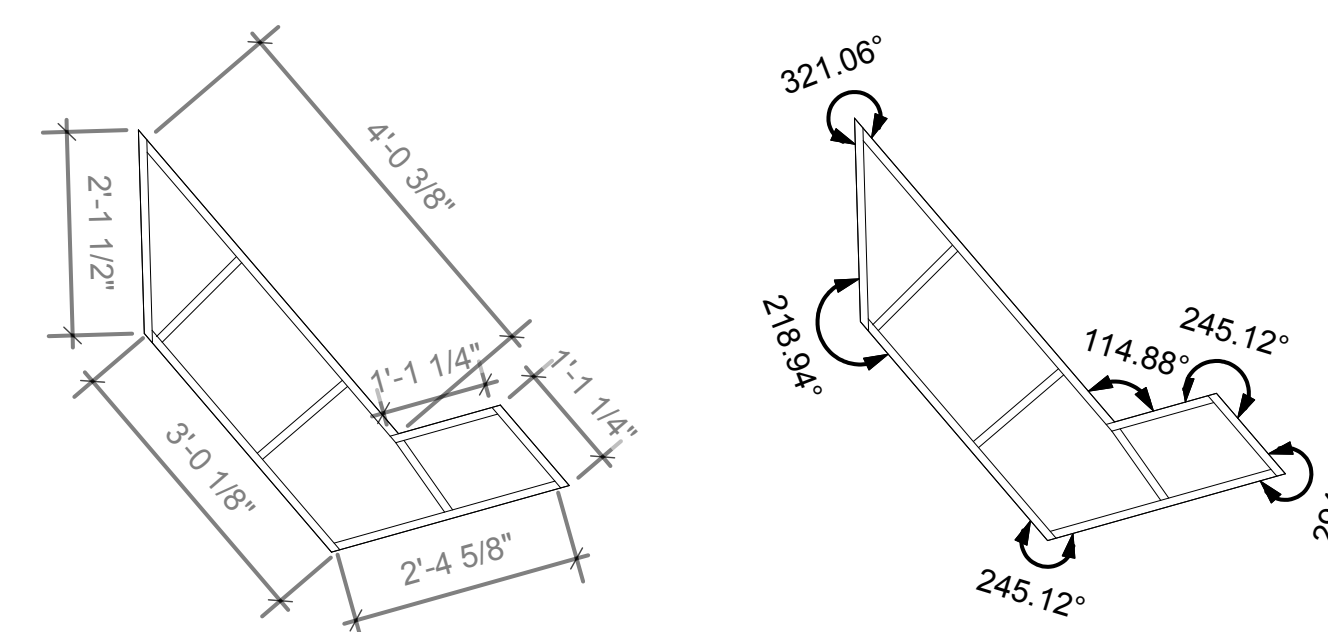

Cutlist for Stair unit C1

- 1x1 box steel
- 1@4'-0 3/8" LL
- 1@3'-0 1/8" LL
- 1@2'-4 5/8" LS
- 1@2'-1 1/2" LS
- 2@1'-1 1/4" LS
- 6@15"

+16"

Stair unit C2

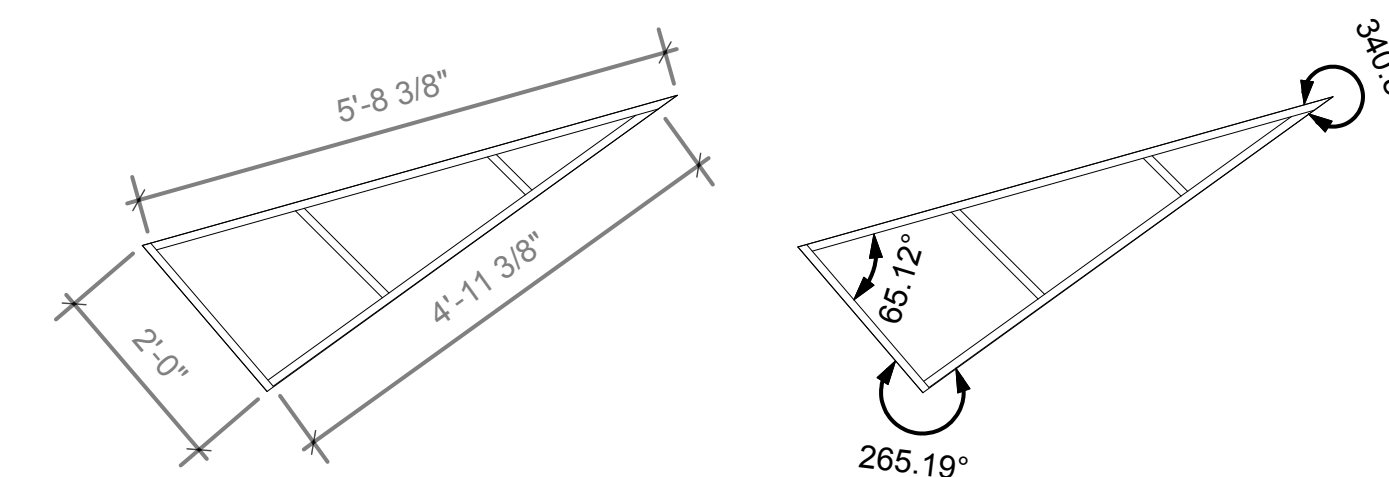

Cutlist for Stair unit C2

- 1x1 box steel
- 1@5'-8 3/8" LL
- 1@4'-11 3/8" LS
- 1@2'-0" LS
- 5@7"

+8"

Notes:

- the stair units will get decked with 3/4" ply and 1/4 maso
- no facing on the stair units
- even though two units are shown, only one unit gets built for each

University of Virginia			
God's Ear			
Water wall and step unit detail			PLATE NO.
DIRECTOR:	Sandi Shiner		3
DESIGNER:	Tom Bloom and Jason Randolph		
TECH DIRECTOR:	Lauren Shell		
DRAFTER:	Lauren Shell		
APPROVED	DATE	SCALE	DWG. DATE
		1/2" = 1'-0"	12.31.2012